

Civic X102

Installation and Maintenance Procedure

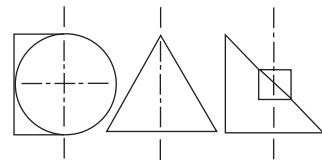

PRODUCT REF:-
C93XX SERIES
C94XX SERIES

Country of origin
United Kingdom
WEE/EA0290TY
IP20 220-240V~50/60 HZ

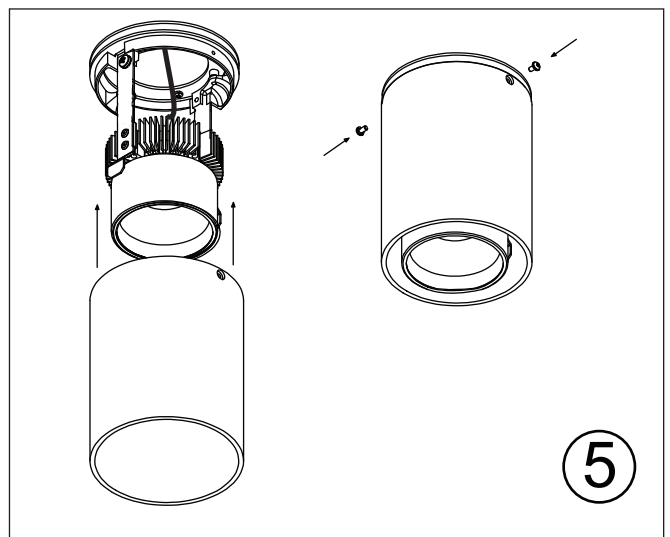
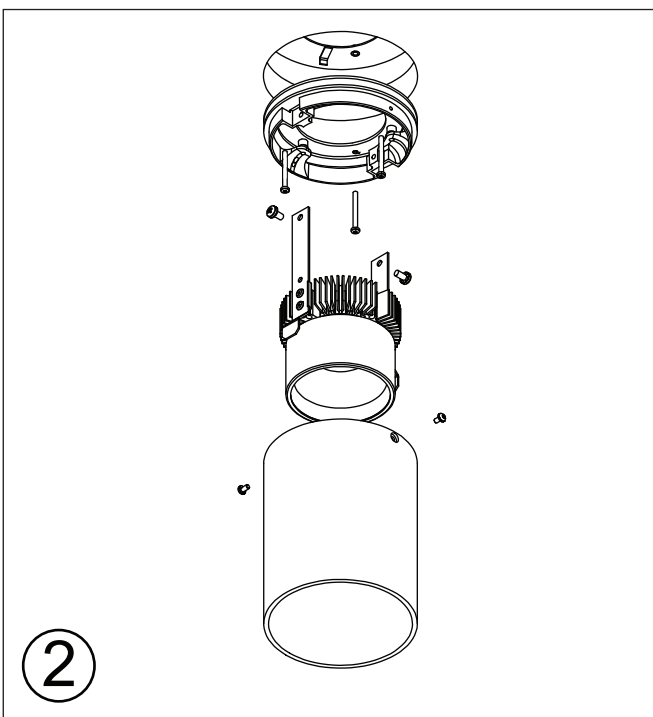
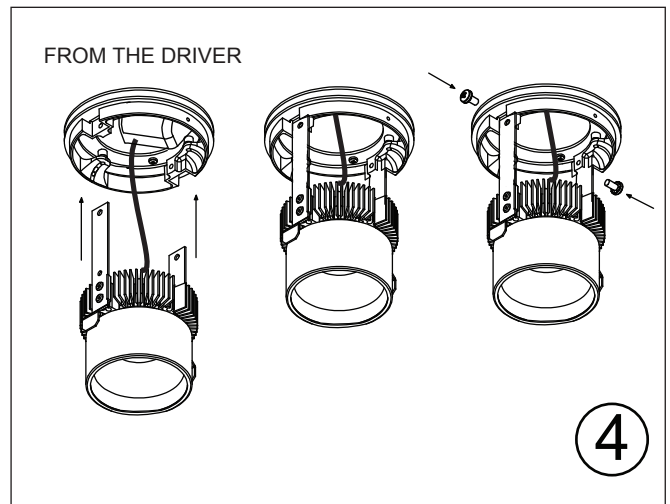
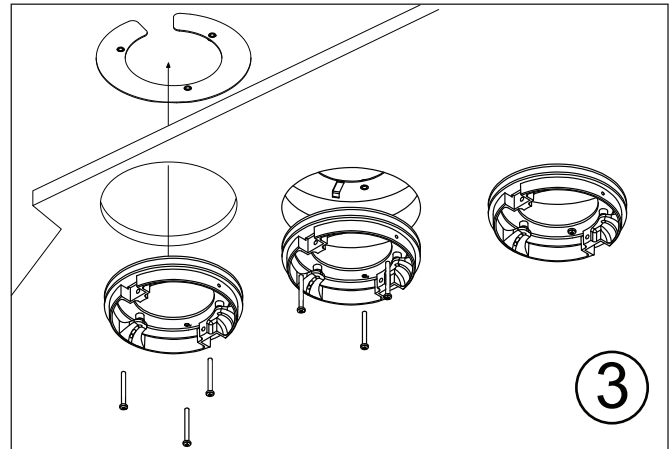
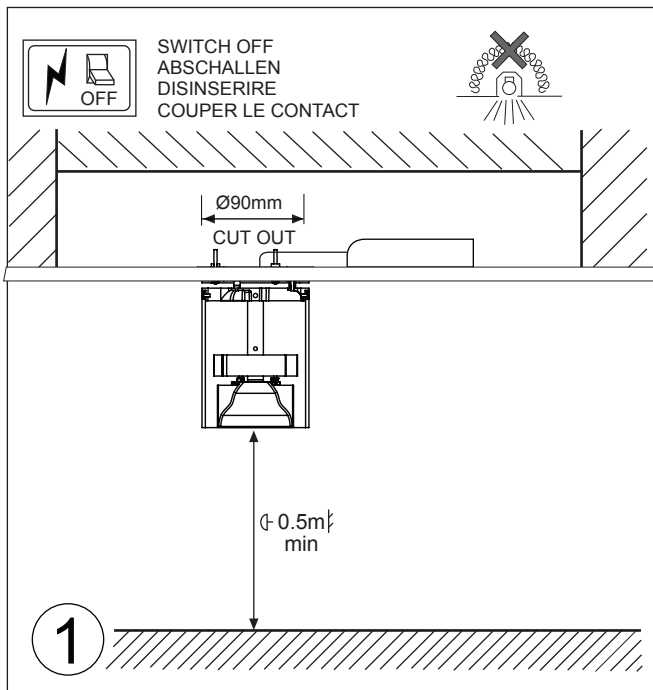

- IP20 DO NOT OPERATE IN DAMP OR CORROSIVE SITUATIONS.
- **WARNING**, SWITCH OFF MAINS BEFORE INSTALLING, OR SERVICING.
- RETAIN PROCEDURE FOR FUTURE USE.

R0-301115

DESIGNED ARCHITECTURAL LIGHTING CO LTD, 6 CONQUEROR COURT, SPILSBY ROAD, HAROLD HILL, ESSEX RM3 8SB, TELEPHONE +44 (0) 1708 381999 FAX+44 (0) 1708 381585 E-MAIL sales@dal-uk.com